

Physical Specification (mm)

| | | |
|------------------------|-----------------------------|------------------------------------|
| Nominal Voltage | | 12V |
| Nominal Capacity(20HR) | | 92Ah |
| Dimension | Length | 353±2mm(13.90inches) |
| | Width | 175±2mm(6.89inches) |
| | Container Height | 190±2mm(7.48inches) |
| | Total Height(with Terminal) | 190±2mm(7.48inches) |
| Weight With Acid | | Approx 26.5Kg(58.4lbs) |
| Acid | | 1.30±0.015g/cm ³ (25°C) |
| Standard Terminal | | 1 |
| Cell layout | | 0 |
| Hold-Down | | / |
| Case | | Black-Material (PP) |
| Cover | | Black-Material (PP) |
| Handle | | Black-Material (PP) |

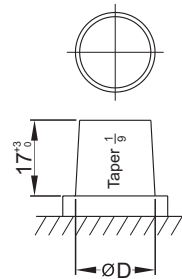

Dimensions (mm)

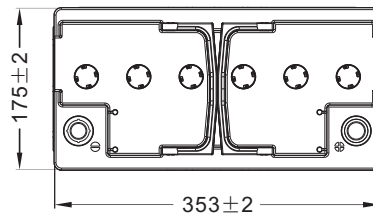
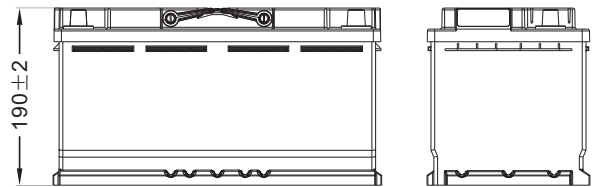

Cell Layout

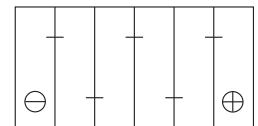

Figure(0)

Electrical Specification

| | | |
|---|--------------------|--------|
| Rated Capacity | 20 hour rate(2.0A) | 92Ah |
| Reserve Capacity (RC)25A@10.5V | | 160min |
| Cold Cranking Performance Amps(CCA) @0°F(-18°C) | | 850A |

Standard Terminal (mm)

| Terminal Type | D | |
|---------------|-----------------------------------|-----------------------------------|
| | Positive | Negative |
| 1 | 19.5 ⁰ _{-0.3} | 17.9 ⁰ _{-0.3} |

Discharge Characteristics

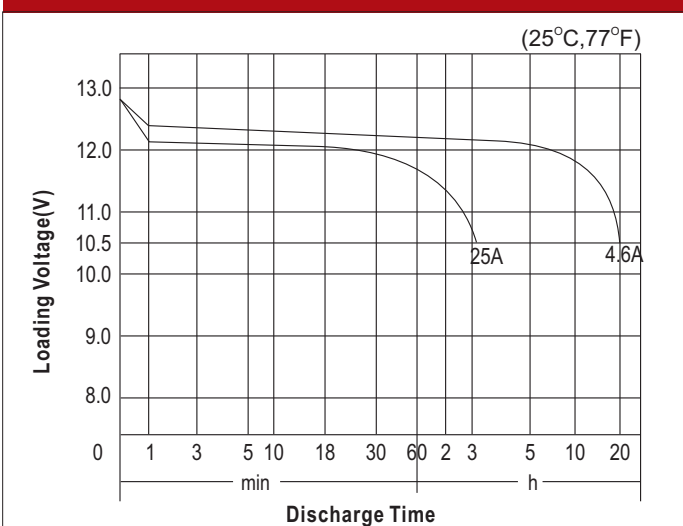

Discharge Characteristics

