

Physical Specification (mm)

Nominal Voltage		12V
Nominal Capacity(20HR)		80Ah
Dimension	Length	315±2mm(12.4inches)
	Width	175±2mm(6.89inches)
	Container Height	190±2mm(7.48inches)
	Total Height(with Terminal)	190±2mm(7.48inches)
Weight With Acid		Approx 24.0Kg(52.9lbs)
Acid		1.30±0.015g/cm ³ (25°C)
Standard Terminal		1
Cell layout		0
Hold-Down		/
Case		Black-Material (PP)
Cover		Black-Material (PP)
Handle		Black-Material (PP)

Electrical Specification

Rated Capacity	20 hour rate(2.0A)	80Ah
Reserve Capacity (RC)25A@10.5V		140min
Cold Cranking Performance Amps(CCA) @0°F(-18°C)		800A

Standard Terminal (mm)

Terminal Type	D	
	Positive	Negative
1	19.5 ⁰ _{-0.3}	17.9 ⁰ _{-0.3}



Dimensions (mm)

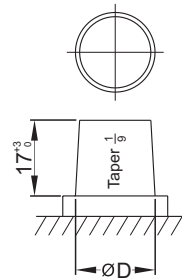
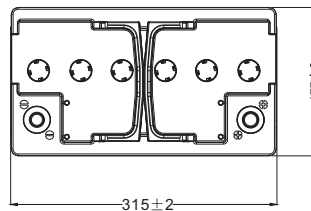
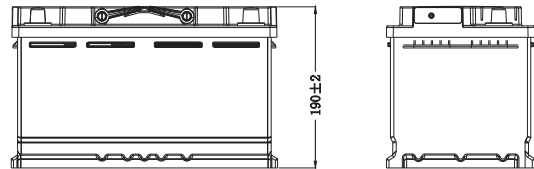

Cell Layout

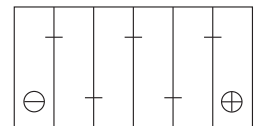

Figure(0)

Discharge Characteristics

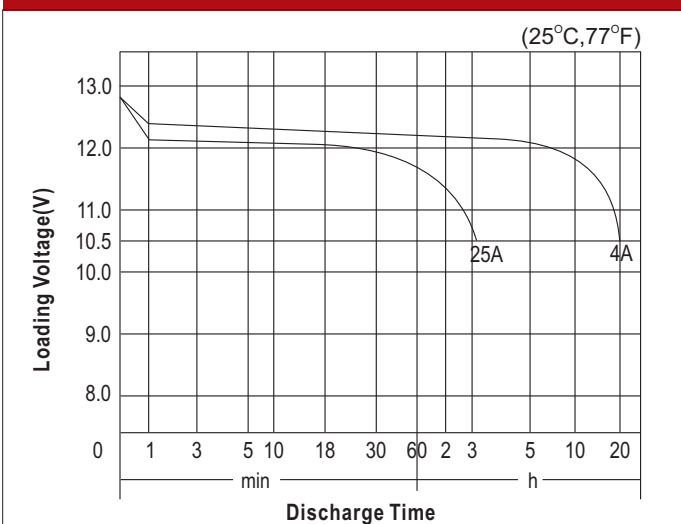

Discharge Characteristics

