

### Physical Specification (mm)

Nominal Voltage		12V
Nominal Capacity(20HR)		70Ah
Dimension	Length	278±2mm(10.94inches)
	Width	175±2mm(6.89inches)
	Container Height	190±2mm(7.48inches)
	Total Height(with Terminal)	190±2mm(7.48inches)
Weight With Acid		Approx 21.3Kg(46.9lbs)
Acid		1.30±0.015g/cm <sup>3</sup> (25°C)
Standard Terminal		1
Cell layout		0
Hold-Down		/
Case		Black-Material (PP)
Cover		Black-Material (PP)
Handle		Black-Material (PP)

### Electrical Specification

Rated Capacity	20 hour rate(2.0A)	70Ah
Reserve Capacity (RC)25A@10.5V		120min
Cold Cranking Performance Amps(CCA) @0°F(-18°C)		760A

### Standard Terminal (mm)

Terminal Type	D	
	Positive	Negative
1	19.5 <sup>0</sup> <sub>-0.3</sub>	17.9 <sup>0</sup> <sub>-0.3</sub>



### Dimensions (mm)

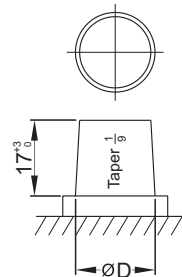
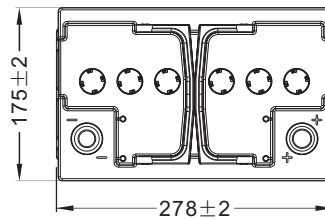
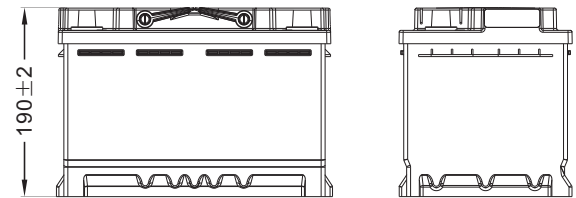

### Cell Layout

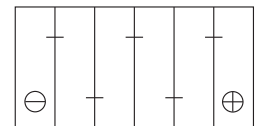

Figure(0)

### Discharge Characteristics

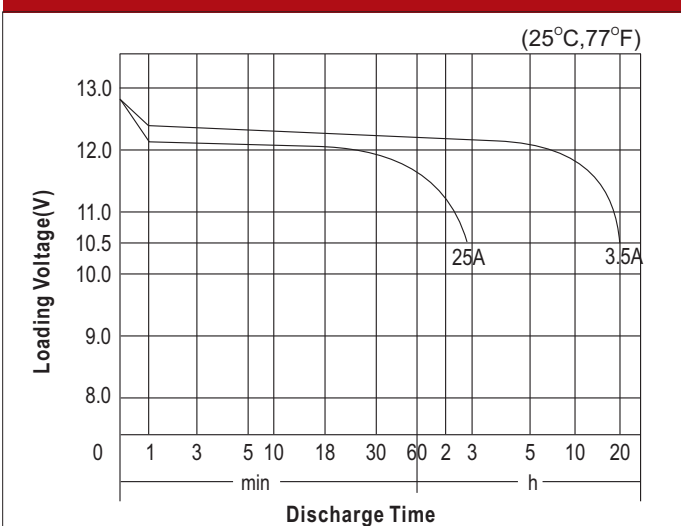

### Discharge Characteristics

