

Physical Specification (mm)

Nominal Voltage		12V
Nominal Capacity(20HR)		60Ah
Dimension	Length	242 ± 2mm(9.53inches)
	Width	175 ± 2mm(6.89inches)
	Container Height	190 ± 2mm(7.48inches)
	Total Height(with Terminal)	190 ± 2mm(7.48inches)
Weight With Acid		Approx 18.8Kg(41.4lbs)
Acid		1.30 ± 0.015g/cm ³ (25°C)
Standard Terminal		1
Cell layout		0
Hold-Down		/
Case		Black-Material (PP)
Cover		Black-Material (PP)
Handle		Black-Material (PP)

Electrical Specification

Rated Capacity	20 hour rate(2.0A)	60Ah
Reserve Capacity (RC)25A@10.5V		100min
Cold Cranking Performance Amps(CCA) @0°F(-18°C)		680A

Standard Terminal (mm)

Terminal Type	D	
	Positive	Negative
1	19.5 ⁰ _{-0.3}	17.9 ⁰ _{-0.3}



Dimensions (mm)

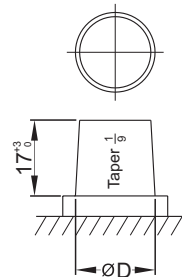
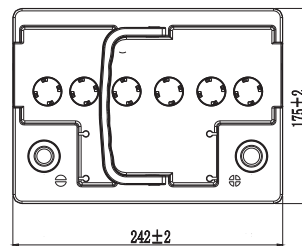
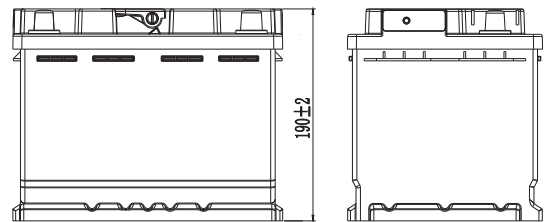

Cell Layout

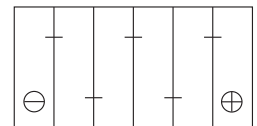

Figure(0)

Discharge Characteristics

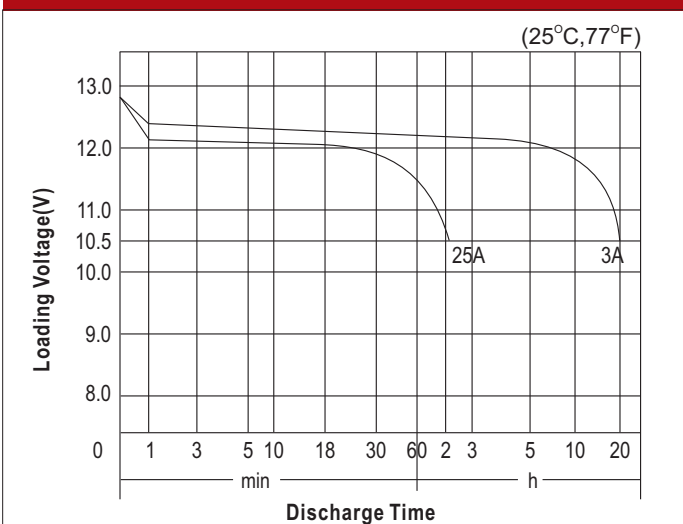

Discharge Characteristics

