

### Physical Specification (mm)

Nominal Voltage		12V
Nominal Capacity(20HR)		50Ah
Dimension	Length	207 ± 2mm(8.15inches)
	Width	175 ± 2mm(6.89inches)
	Container Height	190 ± 2mm(7.48inches)
	Total Height(with Terminal)	190 ± 2mm(7.48inches)
Weight With Acid		Approx 15.5Kg(34.1lbs)
Acid		1.30 ± 0.015g/cm <sup>3</sup> (25°C)
Standard Terminal		1
Cell layout		0
Hold-Down		/
Case		Black-Material (PP)
Cover		Black-Material (PP)
Handle		Black-Material (PP)

### Electrical Specification

Rated Capacity	20 hour rate(2.0A)	50Ah
Reserve Capacity (RC)25A@10.5V		80min
Cold Cranking Performance Amps(CCA) @0°F(-18°C)		570A

### Standard Terminal (mm)

Terminal Type	D	
	Positive	Negative
1	19.5 <sup>0</sup> <sub>-0.3</sub>	17.9 <sup>0</sup> <sub>-0.3</sub>



### Dimensions (mm)

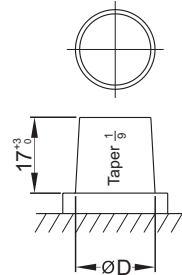
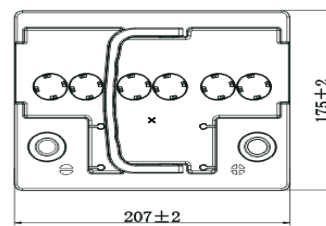
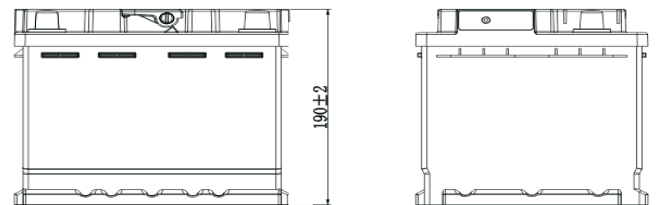

### Cell Layout

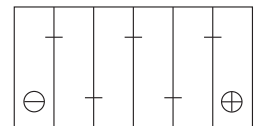

Figure(0)

### Discharge Characteristics

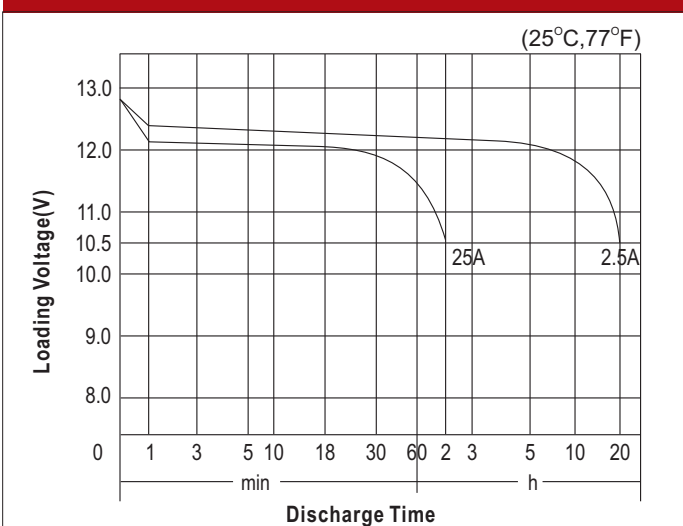

### Discharge Characteristics

